

**GREAT NECK
UNION FREE SCHOOL DISTRICT**

March 13, 2017

RECOMMENDED BOND ITEMS

BBS ARCHITECTS, LANDSCAPE ARCHITECTS & ENGINEERS, P.C.

COST TOTALS BY BUILDING

| COST ELEMENTS "A LIST" | |
|--------------------------------|----------------------|
| | "A List" |
| NORTH HIGH SCHOOL | \$ 6,420,000 |
| SOUTH HIGH SCHOOL | \$ 15,365,000 |
| NORTH MIDDLE SCHOOL | \$ 11,983,000 |
| SOUTH MIDDLE SCHOOL | \$ 13,300,150 |
| PARKVILLE SCHOOL | \$ 2,095,000 |
| JOHN F. KENNEDY SCHOOL | \$ 5,120,000 |
| SADDLE ROCK SCHOOL | \$ 5,300,000 |
| LAKEVILLE SCHOOL | \$ 5,436,000 |
| E. M. BAKER SCHOOL | \$ 8,134,067 |
| VILLAGE SCHOOL | \$ 758,000 |
| GRACE AVENUE SCHOOL | \$ 400,000 |
| CLOVER AVENUE SCHOOL | \$ 1,476,000 |
| PHIPPS ADMINISTRATION | \$ 2,060,000 |
| NEW CUMBERLAND BUILDING | \$ - |
| | |
| TOTALS: | \$ 77,847,217 |
| | |

**GREAT NECK PUBLIC SCHOOLS
BOND REFERENDUM PROJECTS**

3/13/2017

| ITEM NO. | ITEM DESCRIPTION | A LIST ITEMS |
|---------------------------------------|--|---------------------|
| NORTH HIGH SCHOOL | | |
| 1 | Renovate Library/Media Center | \$ 502,800 |
| 2 | High School Library Casework | \$ 135,000 |
| 3 | High School Library Technology | \$ 115,000 |
| 4 | New Lower Parking Lot (97 Stalls) | \$ 591,700 |
| 5 | Reconfigure Science Labs 110, 110A, 111 | \$ 684,000 |
| 6 | Reconfigure Science Labs 208, 208A, 207 | \$ 684,000 |
| 7 | High School Science Casework | \$ 600,000 |
| 8 | High School Science Technology | \$ 150,000 |
| 9 | Classroom Air Conditioning (7 rooms) | \$ 87,500 |
| 10 | New Electrical Panels | \$ 135,000 |
| 11 | Reconfigure Polo Road Corner Parking Lot (add to new 97-stall lot) | \$ 60,000 |
| 12 | North HS Additional Slate Not Covered In Cap Reserve | \$ 1,300,000 |
| 13 | North High School Windows (street façade only) | \$ 1,250,000 |
| 14 | Aerobics Room Air Conditioning (Split Units) | \$ 125,000 |
| <u>NORTH HIGH SCHOOL TOTAL</u> | | \$ 6,420,000 |

| | | |
|---------------------------------------|--|----------------------|
| SOUTH HIGH SCHOOL | | |
| 15 | Renovate Library/Media Center | \$ 792,000 |
| 16 | High School Library Casework | \$ 185,000 |
| 17 | High School Library Technology | \$ 150,000 |
| 18 | Classroom Air Conditioning (20 rooms) | \$ 250,000 |
| 19 | New Electrical Panels | \$ 220,000 |
| 20 | Renovate rooms 319 & 323 to Testing Suite | \$ 302,360 |
| 21 | Replace lockers in Boy's PE & Team East Gym, Renovate Showers and Coaches toilet | \$ 425,640 |
| 22 | Roofing Replacment | \$ 6,000,000 |
| 23 | Replace Roof Drains, Install Leaching Basins | \$ 200,000 |
| 24 | Window Replacement | \$ 4,640,000 |
| 25 | Replace Rooftop HVAC and Exhaust Units (60% of entire complex) | \$ 1,800,000 |
| 26 | Music 306 & 309 Air Cond (Split Units) | \$ 400,000 |
| <u>SOUTH HIGH SCHOOL TOTAL</u> | | \$ 15,365,000 |

| | | |
|---|---|----------------------|
| NORTH MIDDLE SCHOOL | | |
| 27 | Renovate Library/Media Center | \$ 462,000 |
| 28 | Middle School Library Casework | \$ 160,000 |
| 29 | Middle School Library Technology | \$ 133,400 |
| 30 | Replace Auditorium Seating | \$ 313,600 |
| 31 | Replace Curtains & Rigging | \$ 140,000 |
| 32 | Replace Exterior Doors & Hardware | \$ 253,000 |
| 33 | Install Auditorium Sound System | \$ 150,000 |
| 34 | Classroom Air Conditioning (6 rooms) | \$ 75,000 |
| 35 | New Electrical Panels | \$ 90,000 |
| 36 | Auditorium House Lighting to LED | \$ 150,000 |
| 37 | FACS Room Reconstruction | \$ 465,000 |
| 38 | Renovate Room 134 to STEM Lab | \$ 468,000 |
| 39 | Roof Replacement | \$ 4,850,000 |
| 40 | Window Replacement | \$ 2,950,000 |
| 41 | Auditorium Air Conditioning (Split Units) | \$ 300,000 |
| 42 | Masonry Repair | \$ 1,023,000 |
| <u>NORTH MIDDLE SCHOOL TOTAL</u> | | \$ 11,983,000 |

| | | | |
|----|--|-----------|--------------------------|
| | | | |
| | SOUTH MIDDLE SCHOOL | | |
| 43 | Renovate Library/Media Center | \$ | 378,000 |
| 44 | Middle School Library Casework | \$ | 160,000 |
| 45 | Middle School Library Technology | \$ | 125,000 |
| 46 | Renovate Student Toilet Rooms | \$ | 275,000 |
| 47 | Replace Auditorium Seating | \$ | 286,650 |
| 48 | Replace Exterior Doors & Hardware | \$ | 281,000 |
| 49 | Add Library Windows in Side Walls | \$ | 83,500 |
| 50 | Interior Door Replacement | \$ | 328,600 |
| 51 | Renovate Faculty Toilet Rooms (700, 300, 200 5 toilet rooms) | \$ | 444,000 |
| 52 | Renovate student toilet rooms | \$ | 158,400 |
| 53 | Roof Replacement | \$ | 4,350,000 |
| 54 | Replace Gutters & Downspouts | \$ | 130,000 |
| 55 | Replacement Rooftop HVAC and Exhaust Units (40% of entire complex) | \$ | 1,200,000 |
| 56 | Auditorium Air Conditioning (Split Units) | \$ | 300,000 |
| 57 | Replace Roof Drains, Install Leaching Basins | \$ | 200,000 |
| 58 | Replace Windows | \$ | 4,600,000 |
| | <u>SOUTH MIDDLE SCHOOL TOTAL</u> | \$ | <u>13,300,150</u> |

| | | | |
|----|---|-----------|-------------------------|
| | | | |
| | PARKVILLE SCHOOL | | |
| 59 | Classroom Air Conditioning (10 rooms) | \$ | 125,000 |
| 60 | New Electrical Panels | \$ | 90,000 |
| 61 | Roof Replacement | \$ | 1,300,000 |
| 62 | Soffit & Fascia Board Replacement | \$ | 130,000 |
| 63 | Auditorium Air Conditioning (Split Units) | \$ | 250,000 |
| 64 | New Electrical Service Upgrade | \$ | 200,000 |
| | <u>PARKVILLE SCHOOL TOTAL</u> | \$ | <u>2,095,000</u> |

| | | | |
|----|--|-----------|-------------------------|
| | | | |
| | JOHN F. KENNEDY SCHOOL | | |
| 65 | Replace Corridors Ceilings | \$ | 387,000 |
| 66 | Renovate Library/Media Center | \$ | 312,000 |
| 67 | Elem School Library Casework | \$ | 135,000 |
| 68 | Elem School Library Technology | \$ | 80,000 |
| 69 | Replace Exterior Doors & Hardware | \$ | 135,000 |
| 70 | Classroom Air Conditioning (26 rooms) | \$ | 325,000 |
| 71 | New Electrical Panels | \$ | 90,000 |
| 72 | Auditorium House Lighting to LED | \$ | 131,000 |
| 73 | Roof Replacement | \$ | 2,950,000 |
| 74 | Auditorium, MP Room Air Conditioning (Split Units) | \$ | 375,000 |
| 75 | New Electrical Service Upgrade | \$ | 200,000 |
| | <u>JOHN F. KENNEDY SCHOOL TOTAL</u> | \$ | <u>5,120,000</u> |

| | | | |
|----|---|-----------|-------------------------|
| | | | |
| | SADDLE ROCK SCHOOL | | |
| 76 | Renovate Library/Media Center | \$ | 423,000 |
| 77 | Elem School Library Casework | \$ | 135,000 |
| 78 | Elem School Library Technology | \$ | 80,000 |
| 79 | Remediate Coal Bin Water Infiltration | \$ | 124,000 |
| 80 | Repave Upper Lot and Upgrade Lighting | \$ | 332,000 |
| 81 | Replace Exterior Doors & Hardware | \$ | 141,000 |
| 82 | Classroom Air Conditioning (18 rooms) | \$ | 225,000 |
| 83 | New Electrical Panels | \$ | 90,000 |
| 84 | Roof Replacement | \$ | 3,500,000 |
| 85 | Auditorium Air Conditioning (Split Units) | \$ | 250,000 |
| | <u>SADDLE ROCK SCHOOL TOTAL</u> | \$ | <u>5,300,000</u> |

| | | | |
|----|--|-----------|-------------------------|
| | | | |
| | LAKEVILLE SCHOOL | | |
| 86 | Replace (1)Exterior Staircase at Perimeter of Property | \$ | 140,000 |
| 87 | Replace Retaining Walls, Fencing, Regrade Fields | \$ | 750,000 |
| 88 | Replace Exterior Doors & Hardware | \$ | 153,000 |
| 89 | Classroom Air Conditioning (40 rooms) | \$ | 500,000 |
| 90 | New Electrical Panels | \$ | 90,000 |
| 91 | PA/Intercom upgrade | \$ | 200,000 |
| 92 | Renovate reading room to small reading intervention spaces | \$ | 262,000 |
| 93 | Roof Replacement | \$ | 2,210,000 |
| 94 | Gutters & Downspouts | \$ | 131,000 |
| 95 | Lakeville Ventilation Compliance & Upgrades | \$ | 750,000 |
| 96 | Auditorium Air Conditioning (Split Units) | \$ | 250,000 |
| | <u>LAKEVILLE SCHOOL TOTAL</u> | \$ | <u>5,436,000</u> |

| | | | |
|----|--|-----------|-------------------------|
| | | | |
| | EM BAKER SCHOOL | | |
| 97 | New Auditorium / Cafeteria Reconstruction / New Toilet Rooms | \$ | 5,734,067 |
| 98 | Roof Replacement | \$ | 2,400,000 |
| | <u>EM BAKER SCHOOL TOTAL</u> | \$ | <u>8,134,067</u> |

| | | | |
|-----|--|-----------|-----------------------|
| | | | |
| | VILLAGE SCHOOL | | |
| 99 | HVAC Upgrades | \$ | 150,000 |
| 100 | New Greenhouse | \$ | 75,000 |
| 101 | Renovate 4 toilet rooms and ADA compliance alterations | \$ | 358,000 |
| 102 | Replace exterior doors and hardware | \$ | 75,000 |
| 103 | PA/Intercom upgrade | \$ | 100,000 |
| | <u>VILLAGE SCHOOL TOTAL</u> | \$ | <u>758,000</u> |

| | | | |
|----------------------------------|---------------------|--|-------------------|
| | | | |
| | GRACE SCHOOL | | |
| 104 | Kitchen upgrades | | \$ 100,000 |
| 105 | Window Replacement | | \$ 300,000 |
| <u>GRACE SCHOOL TOTAL</u> | | | \$ 400,000 |

| | | | |
|---------------------------------------|--------------------------|--|-------------|
| | | | |
| | CUMBERLAND SCHOOL | | |
| 106 | New Cumberland Building | | |
| <u>CUMBERLAND SCHOOL TOTAL</u> | | | \$ - |

| | | | |
|-----------------------------------|------------------------------------|--|---------------------|
| | | | |
| | CLOVER SCHOOL | | |
| 107 | Additions and Interior Alterations | | |
| 108 | Window Replacement | | \$ 1,476,000 |
| <u>CLOVER SCHOOL TOTAL</u> | | | \$ 1,476,000 |

| | | | |
|-----------------------------------|--|--|---------------------|
| | | | |
| | PHIPPS | | |
| 109 | Phipps Wood Cornice | | \$ 205,000 |
| 110 | Phipps Admin Exterior Doors & Hardware | | \$ 55,000 |
| 111 | Phipps Admin Windows (orig wood) | | \$ 1,800,000 |
| <u>CLOVER SCHOOL TOTAL</u> | | | \$ 2,060,000 |

| | | | |
|-------------------------------------|--|--|----------------------|
| <u>BOND REFERENDUM TOTAL</u> | | | \$ 77,847,217 |
|-------------------------------------|--|--|----------------------|

NOTE: "B List" projects - Projects to be included in the Bond Referendum only if all A List projects are completed and under budget. The District expects to fund certain "B List" projects from its existing capital reserve if additional funds are set aside in such reserve by the District in the future. Please note that additional voter authorization for such expenditure from the existing capital reserve would then be required.

**GREAT NECK
UNION FREE SCHOOL DISTRICT**

Plans and Estimates

BBS ARCHITECTS, LANDSCAPE ARCHITECTS & ENGINEERS, P.C.

| | | | | | Raw Cost | | Project Cost | |
|----|-----------------------------------|-------|------|---------------------------------------|----------|---------|--------------|-----------|
| | | | | | | | | |
| 1 | New Construction | 8,700 | SF @ | \$ | 340 | PER SF= | \$ | 2,958,000 |
| 2 | | | | NEW CONSTRUCTION SUBTOTAL | \$ | | \$ | 2,958,000 |
| | | | | | | | \$ | 4,066,987 |
| | | | | | | | \$ | 4,066,987 |
| | | | | | | | \$ | 467.47 |
| | | | | | | | | PER SF |
| 3 | Aud/Cafeteria Reconstruction | 6,250 | SF @ | \$ | 80 | PER SF= | \$ | 500,000 |
| 4 | New Toilets Premium (@ Old Stage) | 750 | SF @ | \$ | 250 | PER SF= | \$ | 187,500 |
| 5 | | | | INTERIOR RECONSTRUCTION SUBTOTAL | \$ | | \$ | 687,500 |
| | | | | | | | \$ | 687,456 |
| | | | | | | | \$ | 257,796 |
| | | | | | | | \$ | 945,251 |
| | | | | | | | \$ | 151.24 |
| | | | | | | | | PER SF |
| 6 | Site Work | 1 | @ | | | | \$ | 250,000 |
| 7 | Sanitary | 1 | @ | | | | \$ | 50,000 |
| 8 | Utilities | 1 | @ | | | | \$ | 125,000 |
| 9 | Environmental Contingency | 1 | @ | | | | \$ | 100,000 |
| 10 | | | | SITE & ENVIRONMENTAL SUBTOTAL | \$ | | \$ | 525,000 |
| | | | | | | | \$ | 343,728 |
| | | | | | | | \$ | 68,746 |
| | | | | | | | \$ | 171,864 |
| | | | | | | | \$ | 137,491 |
| | | | | | | | \$ | 721,828 |
| 11 | | | | SUBTOTAL | \$ | | \$ | 4,170,500 |
| 12 | | | | Contractor General Conditions (7.00%) | \$ | | \$ | 291,935 |
| 13 | | | | SUBTOTAL | \$ | | \$ | 4,462,435 |
| 14 | | | | Design Contingency (5.00%) | \$ | | \$ | 223,122 |
| 15 | | | | Construction Contingency (5.00%) | \$ | | \$ | 234,278 |
| 16 | | | | Escalation (5.00%) | \$ | | \$ | 245,992 |
| 17 | | | | A/E Professional Fees (5.00%) | \$ | | \$ | 258,291 |
| 18 | | | | Owner Soft Costs (6.00%) | \$ | | \$ | 309,950 |
| 19 | | | | TOTAL PROJECT COST | \$ | | \$ | 5,734,067 |
| | | | | | | | \$ | 5,734,067 |
| | | | | | | | \$ | 659.09 |
| | | | | | | | | PER SF |

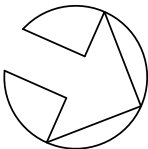

GREAT NECK UNION FREE SCHOOL DISTRICT
PROPOSED ADDITIONS AND ALTERATIONS @ EM BAKER
PROPOSED SITE PLAN DIAGRAM

BBS

Architects
Landscape Architects
Engineers

THE GREAT NECK UNION FREE SCHOOL DISTRICT
69 BAKER HILL ROAD
GREAT NECK, NY 11736

N.T.S.

B-01

03-03-17

REMOVED PLAN

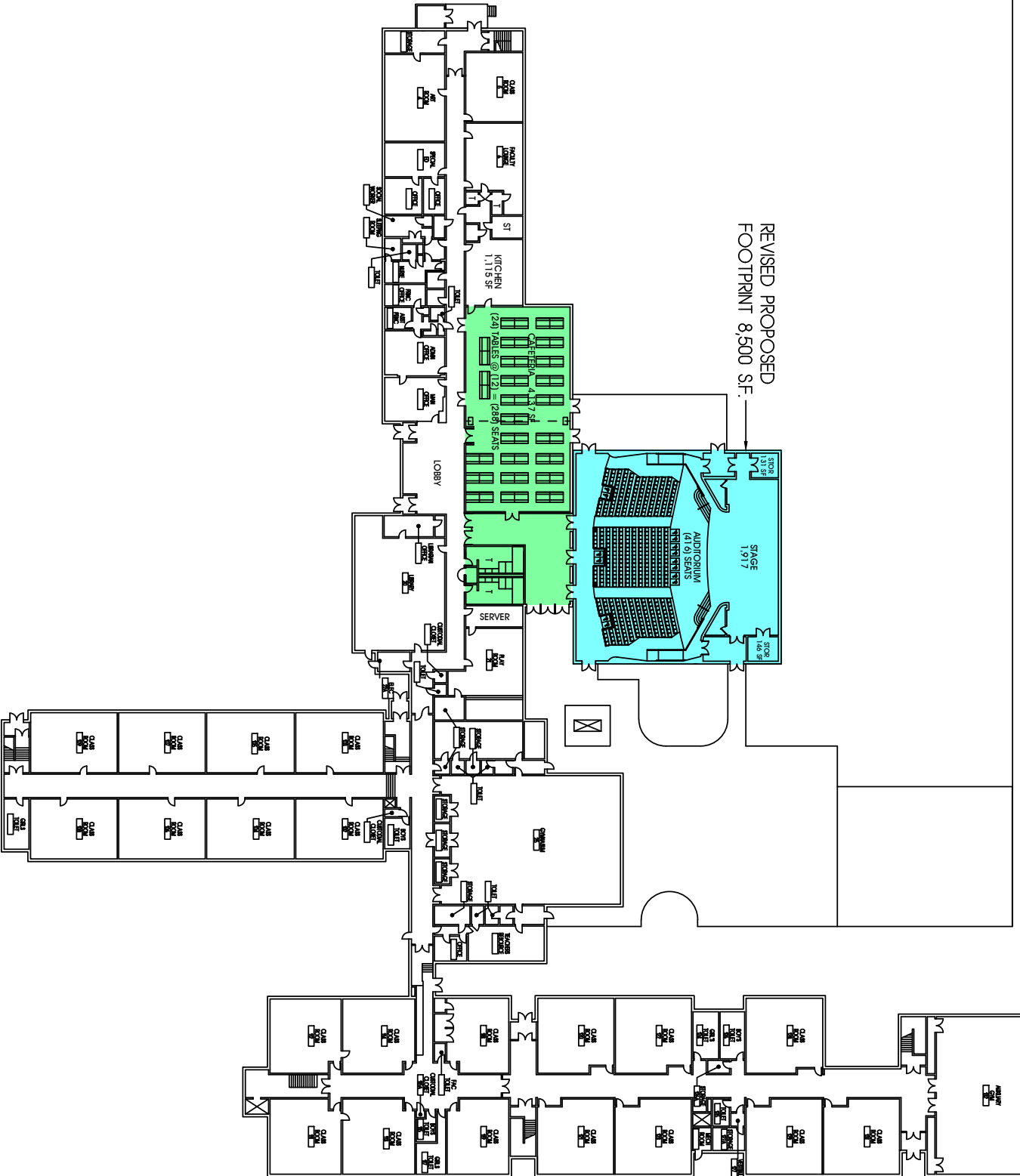

REVISED PROPOSED
FOOTPRINT 8,500 S.F.

GREAT NECK UNION FREE SCHOOL DISTRICT
PROPOSED ADDITIONS AND ALTERATIONS @ EM BAKER
PROPOSED FLOOR PLAN DIAGRAMS



Architects
Landscape Architects
Engineers

2000 GREAT NECK ROAD, GREAT NECK, NEW YORK 11746
TEL: 516.761.3300 FAX: 516.761.3301
WWW.BBSARCHITECTS.COM

N.T.S.

B-02

REVISED PLAN

03-03-17

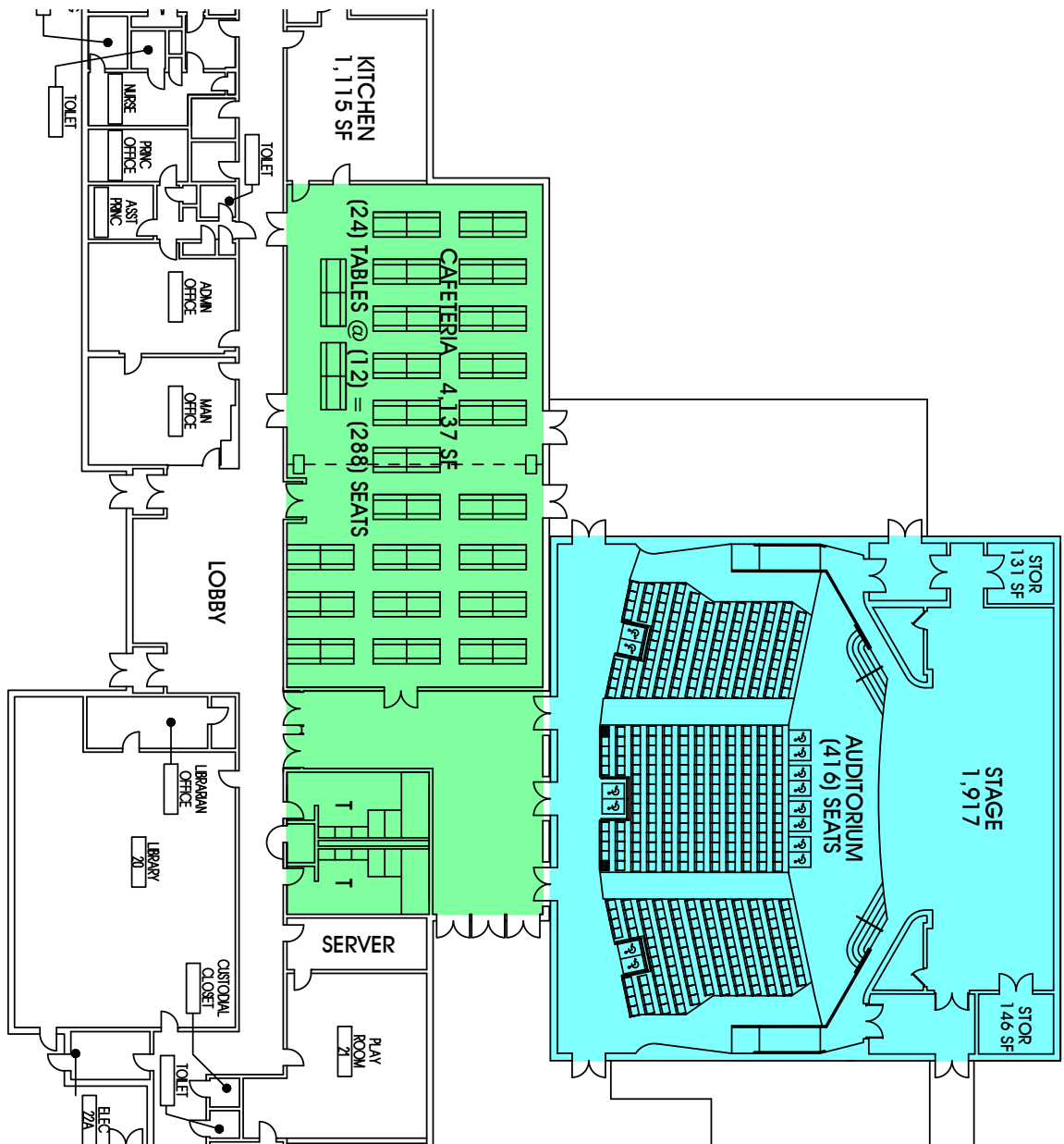

REVISED PLAN

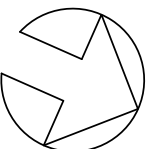

GREAT NECK UNION FREE SCHOOL DISTRICT
 PROPOSED ADDITIONS AND ALTERATIONS @ EM BAKER
 PROPOSED PART FLOOR PLAN DIAGRAMS

BBS

Architects
 Landscape Architects
 Engineers

1000 GREAT NECK UNION FREE SCHOOL DISTRICT
 1000 GREAT NECK UNION FREE SCHOOL DISTRICT
 1000 GREAT NECK UNION FREE SCHOOL DISTRICT

N.T.S.

B-03

03-03-17